

HS-KB



用途 Applications

インバータ装置, 電源装置  
Inverters, Power supply equipment

- 定格電流値 … 500A ~ 1000A  
Rated current … 500A ~ 1000A
- 応答性・直線性および温度特性に優れています  
Superior in response, linearity and temperature characteristics
- 電圧出力と電流出力の両方を準備しました  
Both the voltage output and the current output were prepared
- 外付ヒートシンクにより大電流測定可能  
High current measurement with external heat sink
- HS-Kの派生機種、最大測定電流1600A  
Derivative model of HS-K, maximum measurement current of 1600A

外形寸法図 Dimensions

(mm)

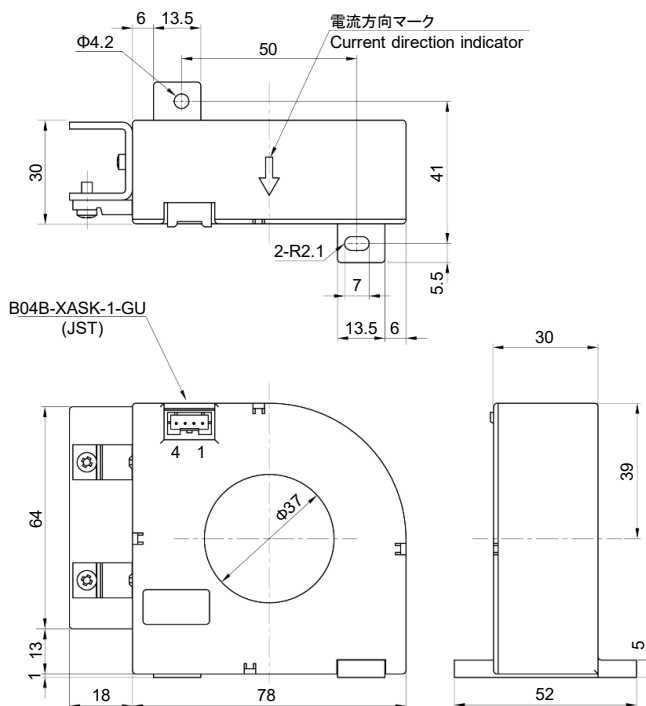

端子番号	1 … 制御電源(+)	(+) terminal
Terminal No.	2 … 制御電源(-)	(-) terminal
	3 … 出力	Output
	4 … GND	GND

質量 Weight : 250g

一般公差: ±0.5  
General tolerance: ±0.5

電気特性 Specification

Ta=25°C

形名 (Type)	電圧出カタイプ (Voltage output type)		電流出カタイプ (Current output type)	
	HS-KB500V4B15J	HS-KBE10V4B15J	HS-KB500A0125B15J	HS-KBE10A025B15J
定格電流 (Rated current) [I <sub>r</sub> ]	±500A	±1000A	±500A	±1000A
連続通電DC電流 (Continuously flowing DC current)	±1000A			
飽和電流 (Saturation current) [I <sub>s</sub> ]	±1600A		±1600A (RL=1~3Ω)	
直線性範囲 (Linearity limits)	0~±1500A		0~±1500A (RL=1~3Ω)	
定格出力 (Rated output) [V <sub>h</sub> , I <sub>h</sub> ]	V0±4V±1.5% (RL=20kΩ)		I0±125mA±1.5%	I0±250mA±1.5%
残留出力 (Residual output) [V0, I0]	Within ±20mV		Within ±0.2mA	
直線性 (Output linearity)	Within ±0.5%			
二次巻線抵抗 (Second coil resistance)	Approx. 24Ω			
応答速度 (Response time)	Within 1μs (at di/dt=100A/μs)			
過渡特性 (Response performance)	Within 20%			
ヒステリシス巾 (Hysteresis voltage range)	Within 20mV		Within 0.2mA	
出力温度特性 (Output Temp. Coef.)	Within ±0.02%/°C			
残留出力温度特性 (Residual output Temp. Coef.)	Within ±1mV/°C		Within ±0.01mA/°C	
制御電源 (Control power supply)	±15V±5%			
消費電流 (Consumption current)	20mA+(Input current/4000)			
使用温度範囲 (Operating Temp.)	-10°C~+80°C			
保存温度範囲 (Storage Temp.)	-15°C~+85°C			
耐電圧 (Dielectric withstand voltage)	4000V AC 50/60Hz 1minute			
絶縁抵抗 (Insulation resistance)	Not less than 500MΩ 500V DC			

Note1) 残留出力値はコアヒステリシス除去後の値です。  
The indicated residual output is the one after the core hysteresis is removed.

特性図 Characteristics chart

HS-KBE10V4B15J (RL=20kΩ)

時間軸 Time base: 5μs/div.

パルス電流応答特性  
Pulse current response characteristic

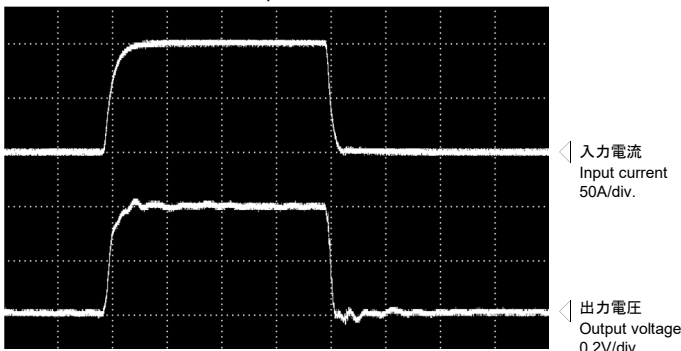

ノイズ特性 (dv/dtの影響)  
Noise characteristics (Effects of dv/dt)

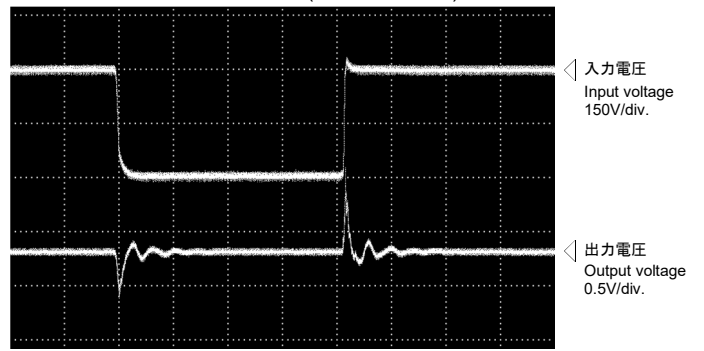

ノイズ特性 (インパルスノイズの影響)  
Noise characteristics (Effects of impulse noise)

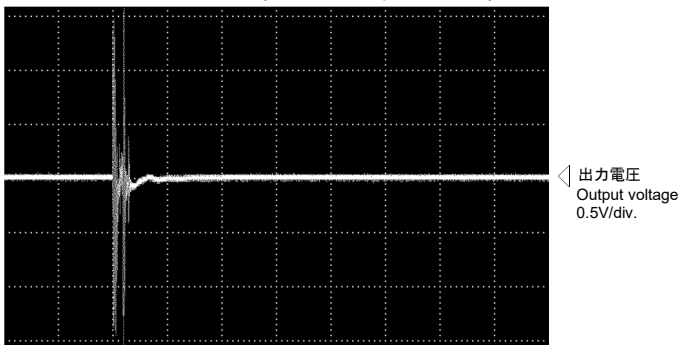

負荷抵抗-出力特性 (電流出カタイプ) Ta=25°C  
Load resistance-output characteristics (Current output type) Ta=25°C

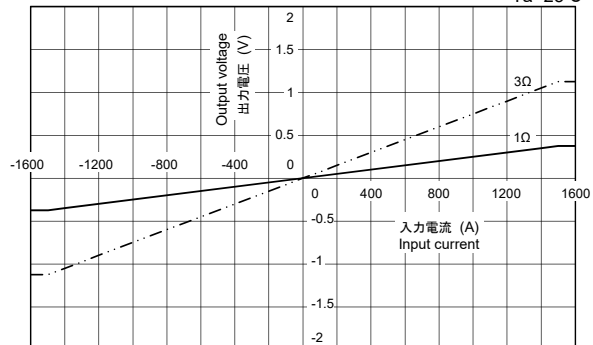

注: "◀"は0Vまたは、0Aを示します。 The marks "◀" means 0V or 0A.