

HC-AM



- 定格電流値 … +150 / -250 A  
Rated current … +150 / -250 A
- 車載バッテリー電流検出用  
For automotive battery current measurement
- ダイレクトカプラ仕様  
Built-in connector type
- 低オフセット温度ドリフト  
Low thermal offset drift
- 5V単電源非レシオメトリック仕様  
5V single power supply, non-ratiometric voltage output

用途 Applications

車載用バッテリー電流検出  
Current detection in automotive battery control

外形寸法図 Dimensions

(mm)

適合コネクタハウジング Supported connector housing  
TH 04 FW-NH(6098-5267)  
(住友電装 Sumitomo Wiring Systems)

端子番号 Terminal No.  
1 … 出力 Output  
2 … GND  
3 … Vcc

質量 Weight : 28g

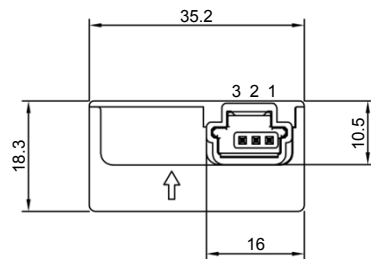

↑ 電流方向  
Current direction

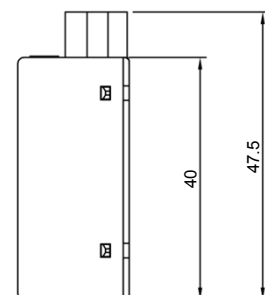
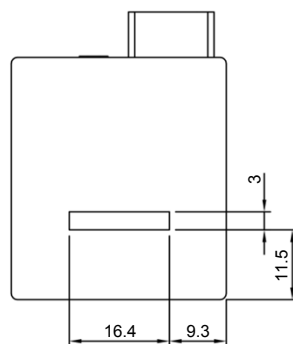

一般公差: ±0.5  
General tolerance: ±0.5

電気特性 Specification

Ta=25°C

形名 (Type)	HC-AM150V15CP5SB	
定格電流 (Rated output) [If]	+If	+150A
	-If	-250A
直線性範囲 (Linearity limits)	-250A~+150A	
入出力特性 (Input-output)	0.5V/-250A, 3V/0A, 4.5V/+150A Non-ratiometric, RL=4.7kΩ	
ゲイン電圧誤差 (Gain error) [Ge]	10mV/A±1.35%	
残留出力 (Residual output) [VO]	3V±15mV	
直線性 (Output linearity)	Within ±0.5%	
応答速度 (Response time)	Within 1ms	
起動時間 (Power up time)	Within 1ms	
ヒステリシス誤差 (Hysteresis Voltage error)	Within -4.7mV~+3.8mV	
ゲイン電圧温度特性 (Gain Temp. Coef.)	Within ±0.035%/°C	
残留出力温度特性 (Residual output Temp. Coef.)	Within ±0.3mV/°C	
制御電源 (Control power supply) [VCC]	+5V±5%	
消費電流 (Consumption current)	Within 10mA	
使用温度範囲 (Operating Temp.)	-40°C~+70°C	
保存温度範囲 (Storage Temp.)	-40°C~+85°C	
耐電圧 (Dielectric withstand voltage)	2000V AC 50/60Hz 1minute	
絶縁抵抗 (Insulation resistance)	Not less than 1000MΩ 500V DC	

Note 1) 残留出力値はコアヒステリシス除去後の値です。 The indicated residual voltage is the one after the core hysteresis is removed.

特性図 Characteristics chart

HC-AM150V15CP5SB

時間軸 Time base: 1ms/div.

応答特性  
Response characteristic

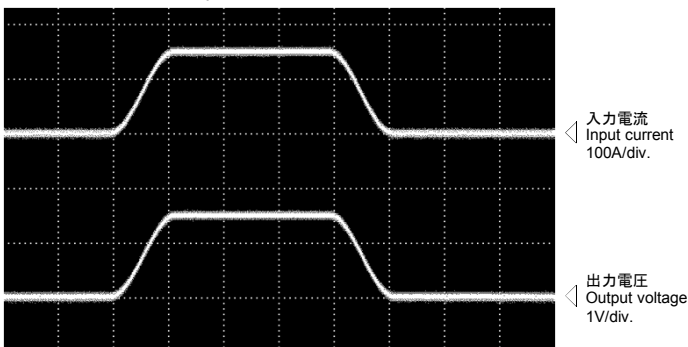

ノイズ特性 (dv/dtの影響)  
Noise characteristics (Effects of dv/dt)

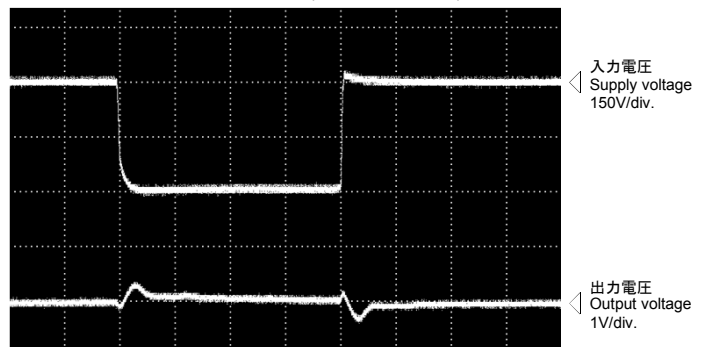

ノイズ特性 (インパルスノイズの影響)  
Noise characteristics (Effects of impulse noise)

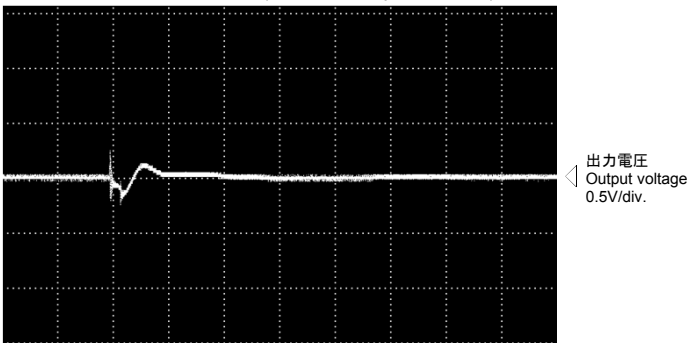

入出力特性  
Input/output characteristics

