

HB-10RS



- 定格一次電流値 …… 15A
Rated primary current …… 15A
- コネクタ接続仕様
Connector Specifications
- ワンタッチクランプ方式で既設の配電盤への取り付けが容易
Simple mounting for exiting panel which is clamp type

用途 Applications

太陽電池ストリング監視、電源装置
Energy measurement unit , power supply equipment

外形寸法図 Dimensions

(mm)

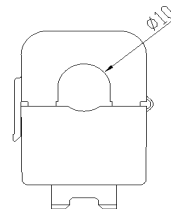
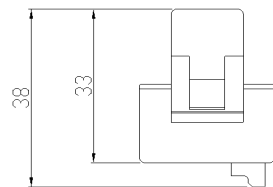
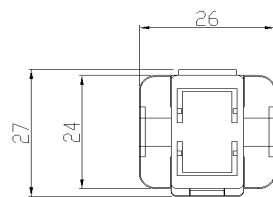

質量 Weight : 24g

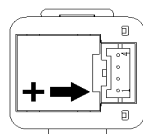

	HB-10R015V4B12C	HB-10R015V2PP5C
1	制御電源(+12V)	制御電源(+5V)
2	制御電源(-12V)	GND
3	出力	出力
4	GND	GND

適合コネクタハウジング
Supported housing
XARP-04V(JST)
XAP-04V-1(JST)

一般公差: ±0.5
General tolerance: ±0.5

接続図
Connection diagram

電気特性 Specification

Ta=25° C

形名 (Type)	HB-10R015V4B12C	HB-10R015V2PP5C
定格電流 (Rated current)	±15A	±15A
飽和電流 (Saturation current)	±33.75A	±16.5A
直線性範囲 (Output Linearity)	0~±30A	0~±15A
定格出力 (Rated output)	Within ±4V±4.5%(RL=10kΩ)	Within V0±2V±90mV(RL=10kΩ)
残留出力 (V0) (Residual output)	Within ±150mV	Within (Vcc/2)±75mV
直線性 (Linearity)	Within ±1%	Within ±1%
応答速度 (Response speed)	Within 10 μs	Within 30 μs
過渡特性 (Transient characteristics)	Within 10%	Within 10%
ヒステリシス巾 (Hysteresis width)	Within 100mV	Within 50mV
出力温度特性 (Output Temperature)	Within ±0.15%/°C	Within ±0.15%/°C
残留出力温度特性 (Residual output Temperature characteristics)	Within ±14mV/°C	Within ±7mV/°C
制御電源 (Vcc) (Control power)	±12V±5%	+5V±2%
消費電流 (Consumption current)	Within 20mA	Within 15mA
使用温度範囲 (Operating Temperature)	-10°C~+80°C	-10°C~+80°C
保存温度範囲 (Storage Temperature range)	-20°C~+85°C	-20°C~+85°C
耐電圧 (Dielectric withstand voltage)	2500V AC 1minute	2500V AC 1minute
絶縁抵抗 (Insulation resistance)	Not less than 500MΩ 500V DC	Not less than 500MΩ 500V DC

Note1) 残留出力値はコアヒステリシス除去後の値です。

The indicated residual output is the one after the core hysteresis is removed.

Note2) 出力仕様は出力抵抗100Ω、最大出力電流は2mA以下です。

Output specifications include 100-Ω output resistance and 2-mA maximum output current.

特性図 Characteristics chart

入-出力特性
Input-output characteristics

